



Published in N magazine

N magazine
2121 Natomas Crossing Dr.
Nº 200-130
Sacramento, CA 95834
916-359-7411
nmag@surewest.net
Published monthly by
N Communications, Inc.
www.nmag.net

May 2010 page 10

Celebrating Neighbors



Regional History

By Martha Mills

The West Sacramento Community Center located at the corner of West Capital and Merkley Avenues will open in September.



Graphics courtesy City of West Sacramento.

Sense of Place

West Sacramento's History Gallery

When the new West Sacramento Community Center opens this fall it will also open a new window to the history and the diverse cultures of this rapidly developing area. West Sacramento Historical Society (WSHS) members Thom Lewis

and Jim Brewer are designing the 209 square-foot delta shaped exhibit space called the History Gallery. Lewis, who created interpretive exhibits for the California Water Department, constructed a scale model of the exhibit space to plan for displays of the society's collection.



(above) West Sacramento Historical Society members Jim Brewer, left, and Thom Lewis, right, point out important elements in the exhibit model.

It will feature enlarged photos and narrative text on 10-foot high panels. Secure display cases will house selected artifacts. Brewer, owner of a local web hosting and software development company, is working on interactive technology to engage gallery visitors.

The gallery will house a permanent exhibit as well

as flexible space for rotating exhibits. Each exhibit will embody the theme "Our Journey" to reflect the varied experiences of the people who have called this area their home.

Located near the front entrance of the Community Center, the gallery is situated to attract seniors visiting the nearby senior lounge, children enrolled in the child development center, members of the general public attending community events in the multi-purpose classrooms or the new black box theatre, and children on field trips from area schools.

WSHS' strategic plan includes working with staff of the new Arthur F. Turner Library to expand the historic reference collection and collaborating with faculty at the neighboring Los Rios Community College Campus Center to provide opportunities for more in-depth study. WSHS has small displays located in businesses, schools, and public facilities throughout the city.

Historical society members are raising funds now to help cover the estimated \$40,000

fabrication cost for Phase I of the history gallery exhibit to be completed by opening day. Contributions are welcome, and should be addressed to the West Sacramento Historical Society.

(below) Gallery blueprint inside the Community Center.

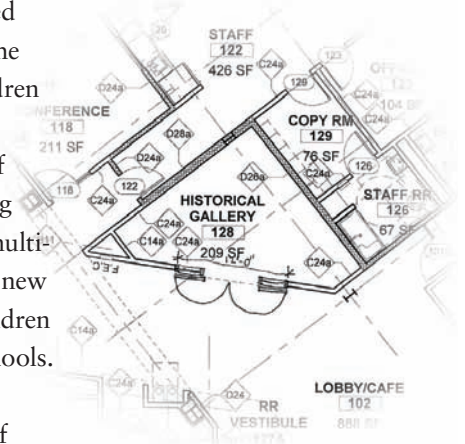

Learn More

N magazine nmag.net

West Sacramento Historical Society
PO Box 1202, West Sacramento, CA 95691
westsachistoricalsociety.org

Donation Information
Martha Mills,
916-365-5379

City of West Sacramento
cityofwestsacramento.org/city/depts/pcs/ccp/default.asp